

ANGULAR RANGE : OPENING 90°~CLOSED

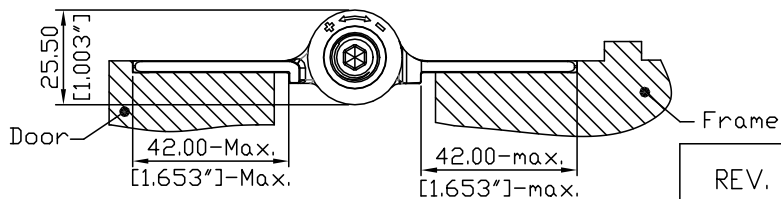

Units: mm

REV. DATE	2020-MAR-27
-----------	-------------

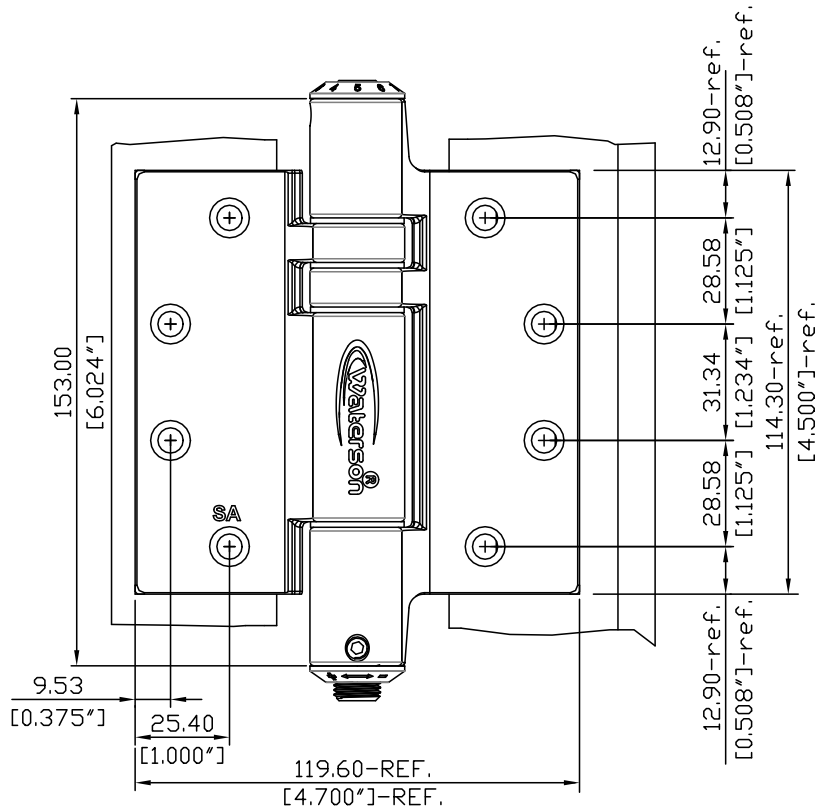
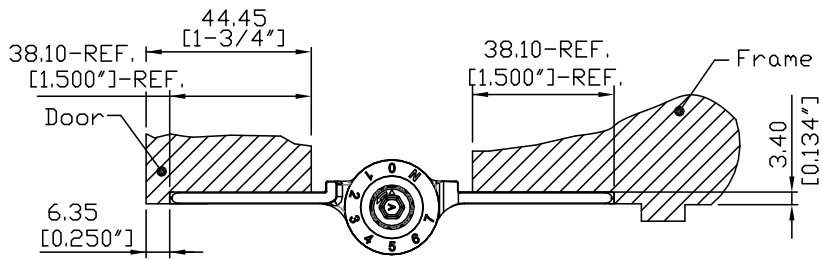
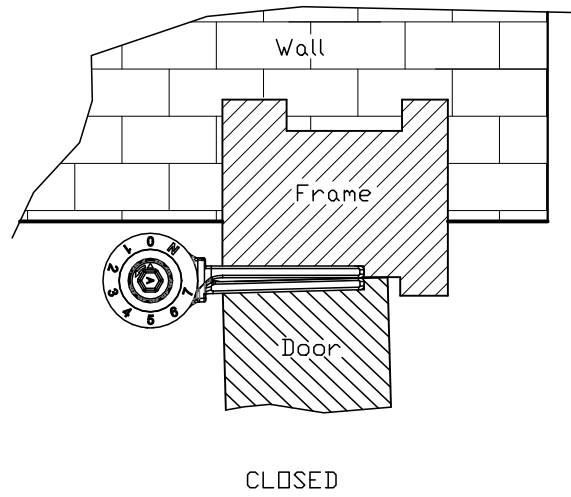
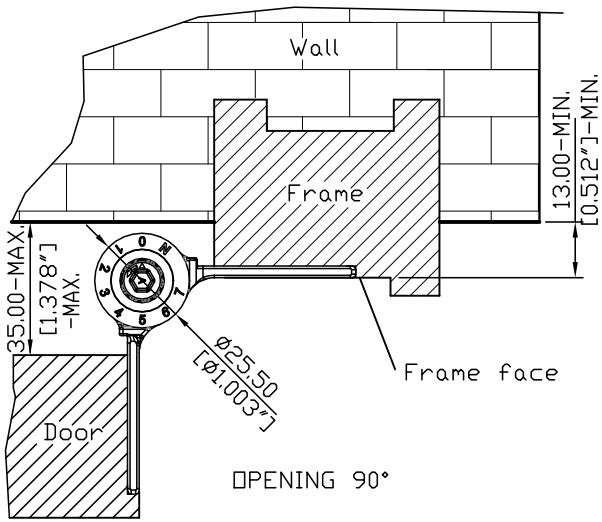

Waterson Closer Hinge System  
Hinges@watersonusa.com

NAME:  
3in1 Waterson Closer Hinge System

Pivot Height:  
6"

Model NO.:  
450131

Material:  
SUS 304 Stainless steel

Template Size:  
4.5"(H)x4.5"(W)

Serial NO.:  
K51M

Standard:  
ANSI A156.7

Door thickness:  
44.45mm (1-3/4")

ANGULAR RANGE : OPENING 90°~CLOSED

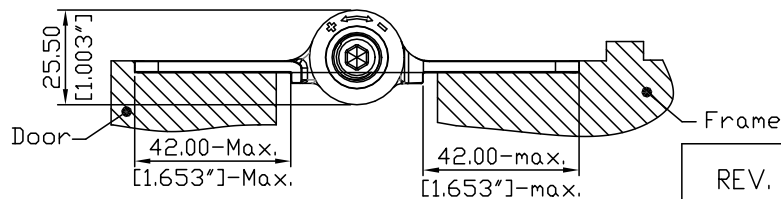
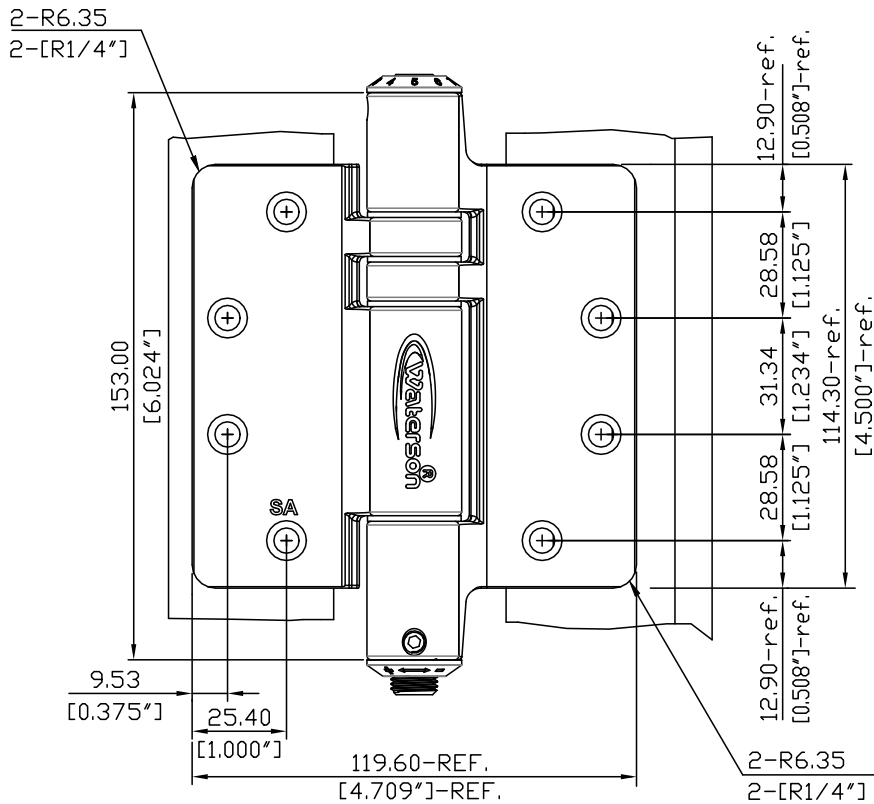
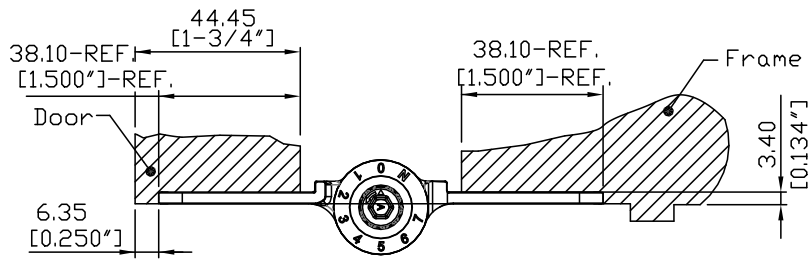
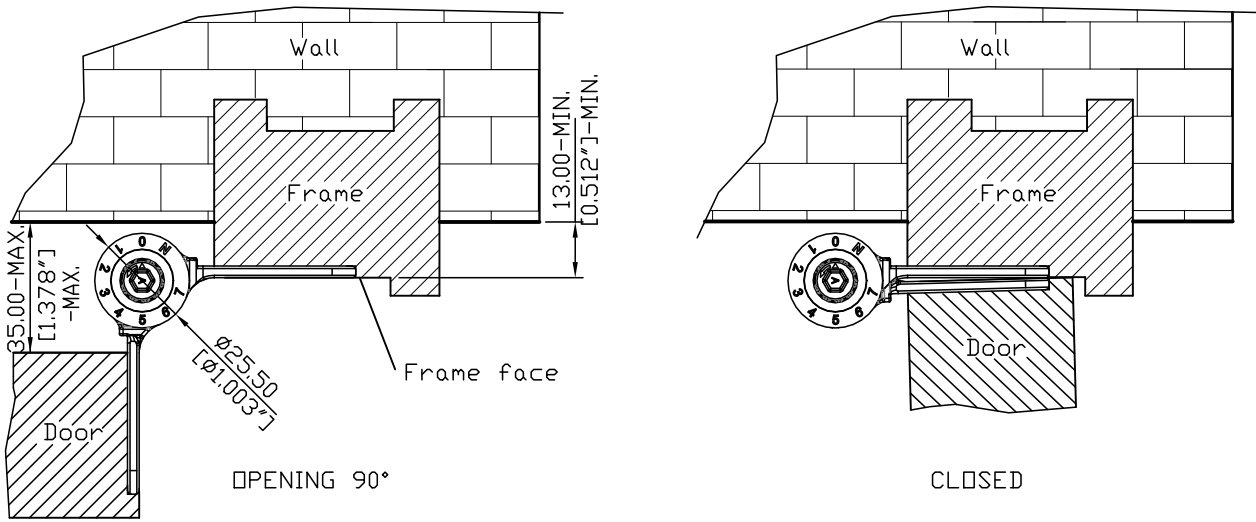

Units: mm

REV. DATE	2020-MAR-27
-----------	-------------



Waterson Closer Hinge System  
Hinges@watersonusa.com

NAME:  
3in1 Waterson Closer Hinge System

Pivot Height:  
6"

Model NO.:  
450131

Material:  
SUS 304 Stainless steel

Template Size:  
4.5"(H)x4.5"(W)-R1/4"

Serial NO.:  
K51M

Standard:  
ANSI A156.7

Door thickness:  
44.45mm (1-3/4")

ANGULAR RANGE : OPENING 90°~CLOSED

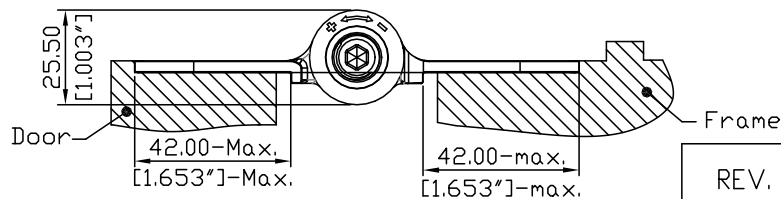
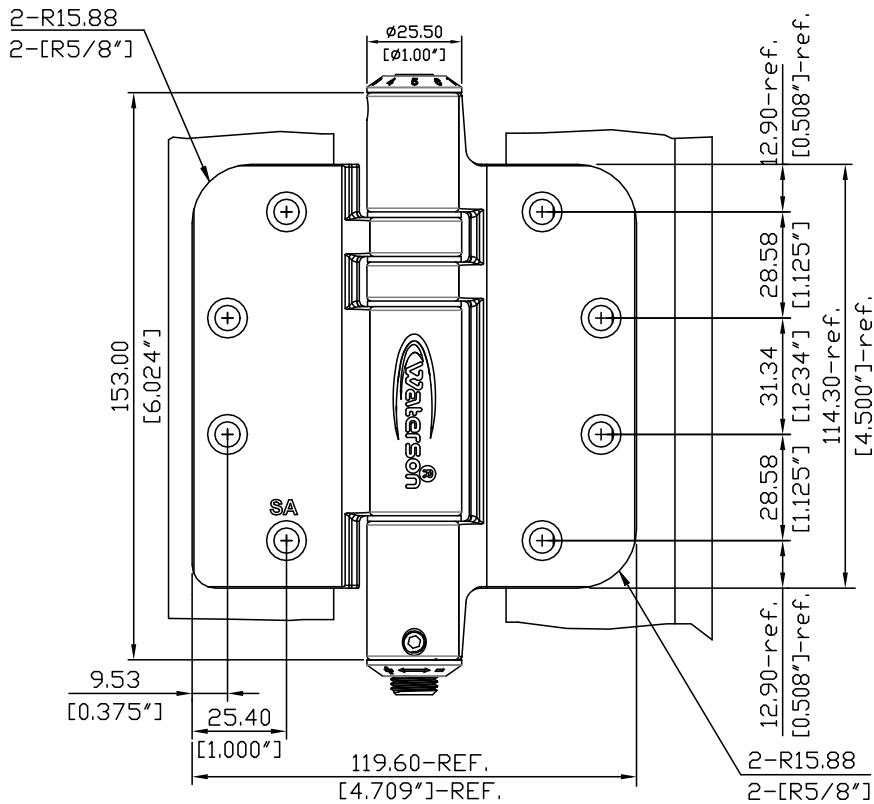
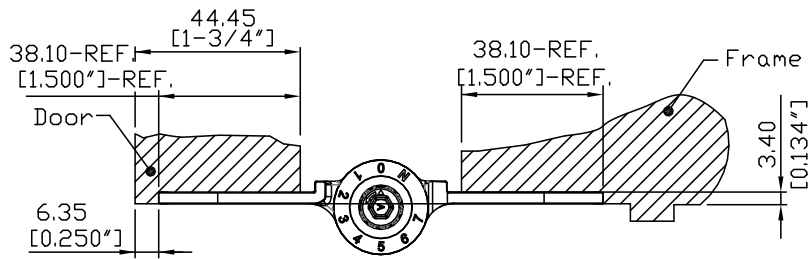
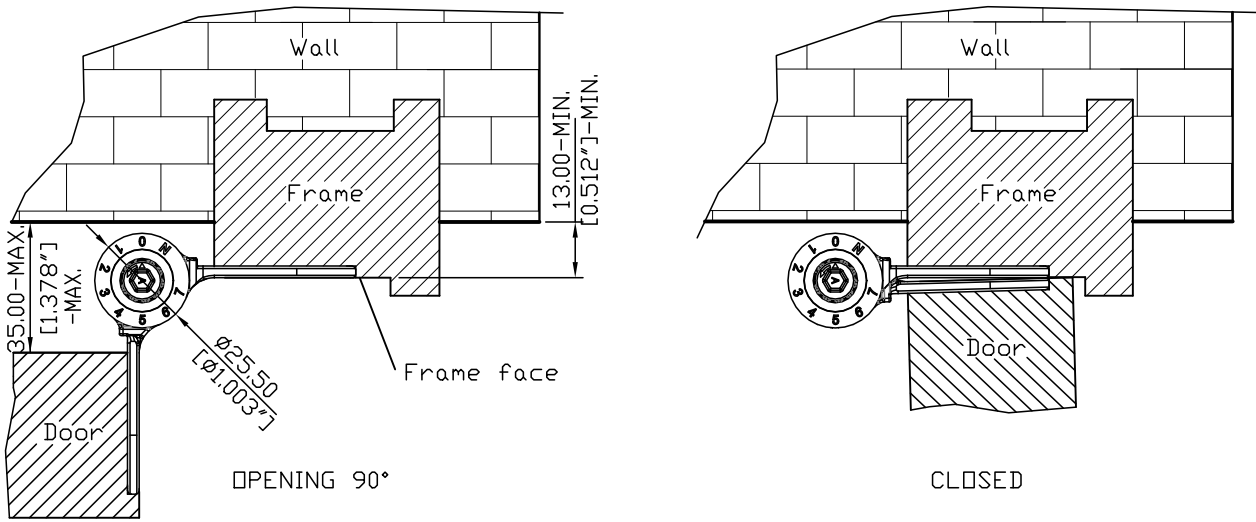

Units: mm

REV. DATE	2020-MAR-27
-----------	-------------



Waterson Closer Hinge System  
Hinges@watersonusa.com

NAME:  
3in1 Waterson Closer Hinge System

Pivot Height:  
6"

Model NO.:  
450131

Material:  
SUS 304 Stainless steel

Template Size:  
4.5"(H)x4.5"(W)-R5/8"

Serial NO.:  
K51M

Standard:  
ANSI A156.7

Door thickness:  
44.45mm (1-3/4")