

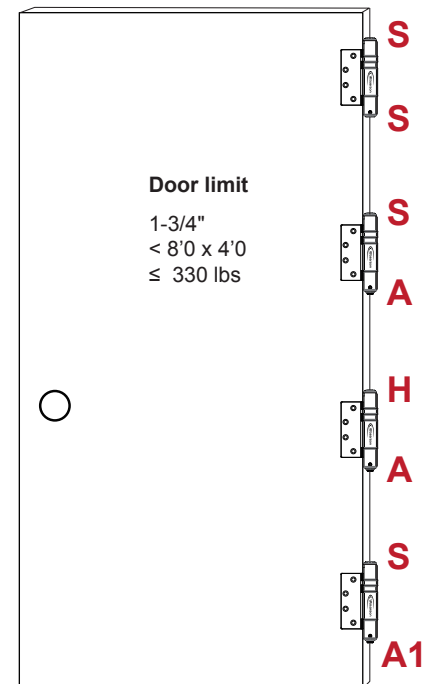

## B.1 Parts Included

Each box includes a complete set of hinges, installation parts and necessary tools.  
**NOTE:** Set B4 includes four hinges; Set B2 includes two hinges.

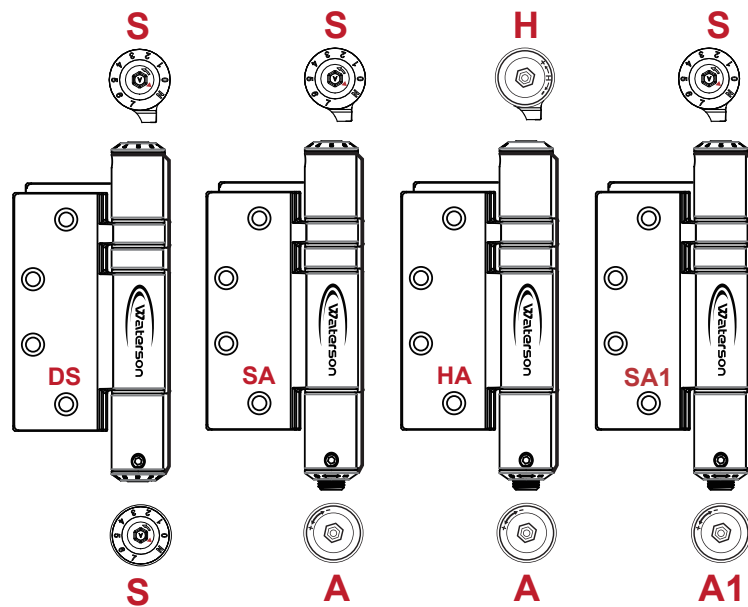
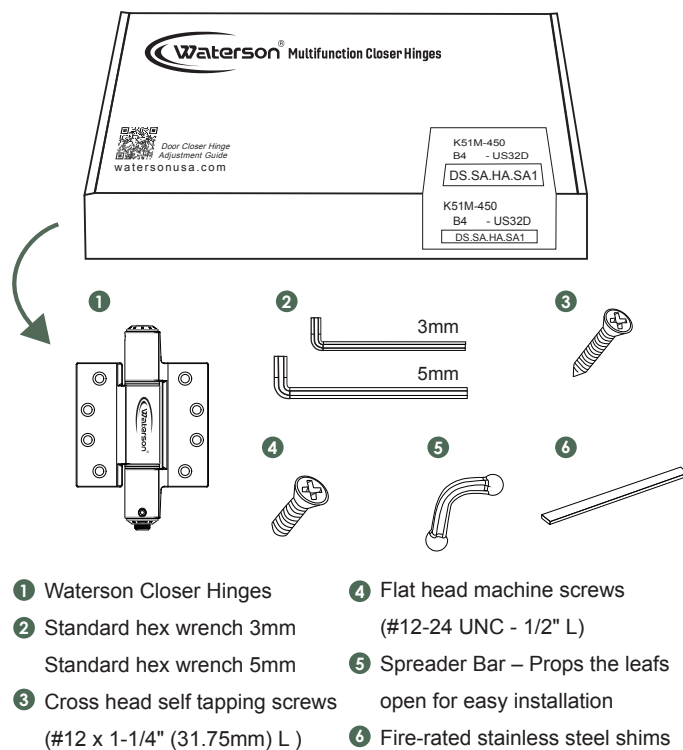

## B.2 Adjustment Steps

Follow the steps below to precisely adjust the speed control and self-closing functions.

**1**

### BEFORE ADJUSTING

Install door so it swings freely and latches. Hinges should be in the following factory settings upon installation:

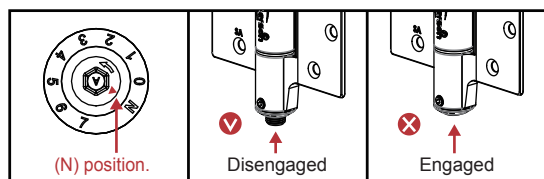

**NOTE:** Hinge positions are interchangeable.

**2**

### SETTING TENSION

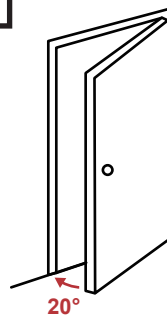

Increase tension one number at a time until door closes and latches from 20°.  
(Refer to B.3-S)

**NOTE:** Optimal function is achieved when hinges are set similarly. Tension settings are cumulative.

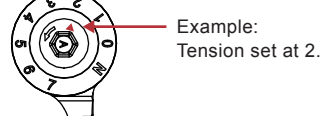

**3**

### ADJUSTING & LATCH SPEED CONTROL

First adjust swing speed control (A) then latch speed control (A1) to avoid slamming. (Refer to B.3-A and B.3-A1)

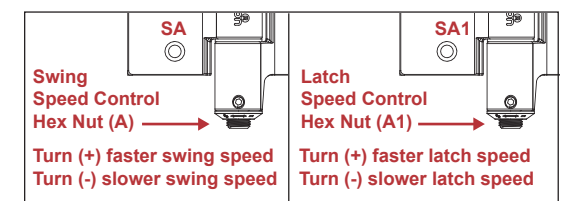

**4**

### ENABLE HYDRAULIC & ADJUST DAMPER

Follow the two steps below to enable hydraulic function:

- Refer B.3 - H1 for Enable Hydraulic Damper.
- Refer B.3 - H2 for Hydraulic Damper Adjustment.

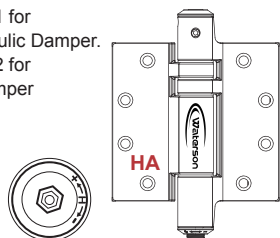

**5**

### LOCK-IN PLACE

Tighten the barrel-side speed lock-in screws on SA, SA1 and HA hinges to ensure that your settings remain fixed.

**NOTE:** Each hinge has two speed lock-in screws. Tighten at least one.

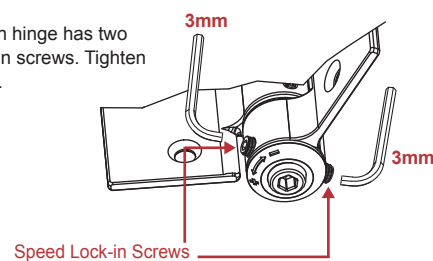

### FINE ADJUSTMENT

Optimize door performance by adjusting: Swing speed (A), Latch speed (A1), and Spring tension (S).

#### ADJUSTMENTS:

- Door Slams: Decrease swing speed, latch speed, or tension.
- Poor Latching: Increase swing speed, latch speed, or tension.

**NOTE:** Adjust speed control gradually, making slight changes each time.

**NOTE:** Increase or decrease spring tension incrementally one number at a time.

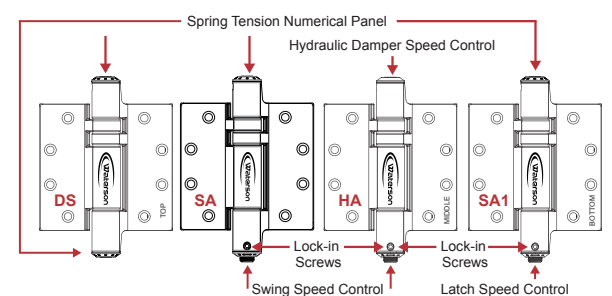

## B.3 How To Adjust

Waterson hinge sets are easily adjustable using 3mm and 5mm hex wrenches. See specific adjustment details (S, A, A1, B, H1 & H2) below.

**S**

### TENSION ADJUSTMENT

Use 5mm hex wrench to adjust numerical panel.

**Increase Tension:** Turn (▲) to greater number.

**Decrease Tension:** Depress and turn to lower number.

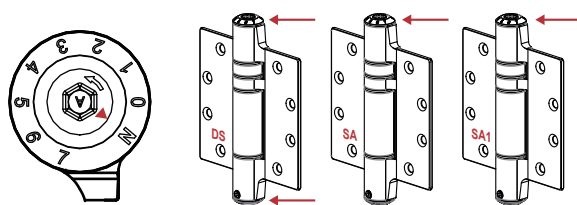

**CAUTION:** Setting tension beyond 5 may decrease spring longevity.

**A**

### SWING SPEED ADJUSTMENT

Use 5mm hex wrench to adjust swing speed, which is only adjusted on SA and HA hinge bottoms.

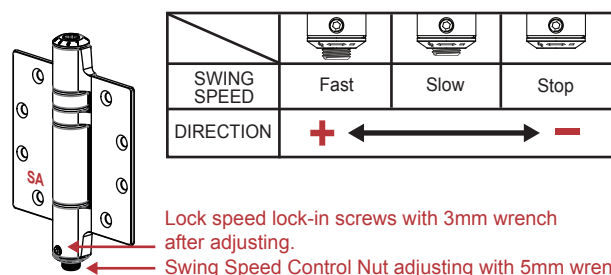

**A1**

### LATCH SPEED ADJUSTMENT

Use 5mm hex wrench to adjust latch speed, which is only adjusted on SA1 hinge bottom.

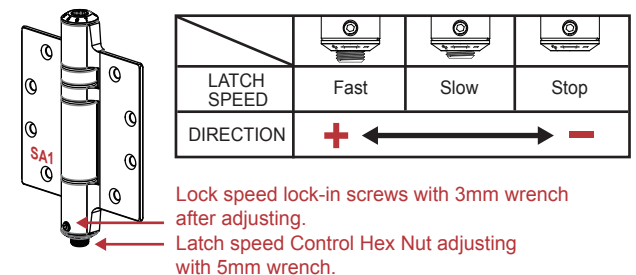

**B**

### HOLD OPEN ADJUSTMENT

Hold-open adjustment is only done on SB hinge bottom.

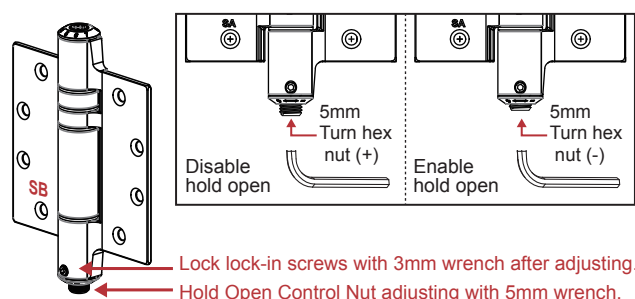

**H1**

### ENABLE HYDRAULIC ADJUSTMENT

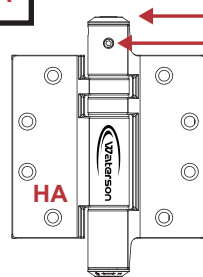

Enable Function (5mm wrench)

2 Turning toward plus (+) one revolution.

Lock-in screw (3mm wrench)

1 Slightly loosen side screw.

3 Lock side screw.

**NOTE:** You can always reset to factory default by turning to full minus (-) with 5mm hex wrench then repeat steps 1-3.

**H2**

### HYDRAULIC DAMPER ADJUSTMENT

Use a 3mm hex wrench to adjust hydraulic damper, which is only done on HA or HS hinges.

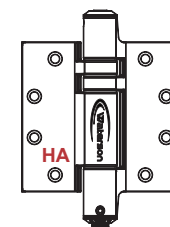

CLOSING SPEED	Fast	Slow	Stop
HYDRAULIC DAMPER	Min	Middle	Max
DIRECTION	+ ← → -		

**NOTE:** Door will stop if you turn full minus (-), and may result in hydraulic mechanism damage.

**CAUTION:** Hydraulic mechanism operates best from 0-120°. Opening beyond 120° may damage hinge and violate warranty.